

Solario

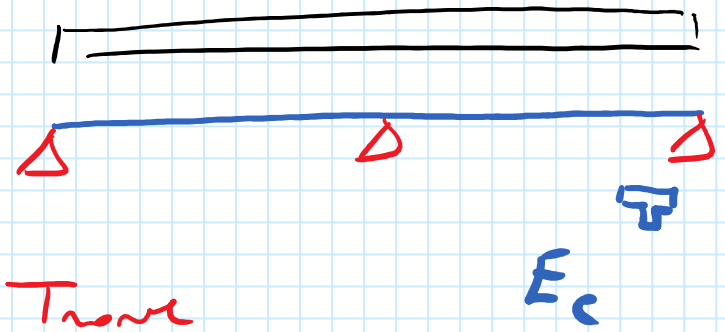

Torne

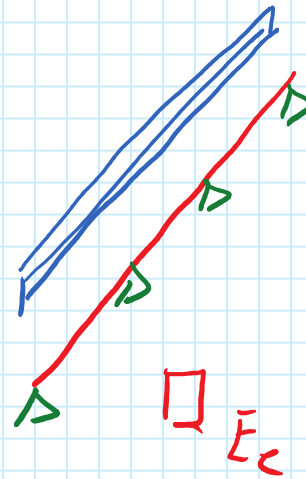

Pilasta

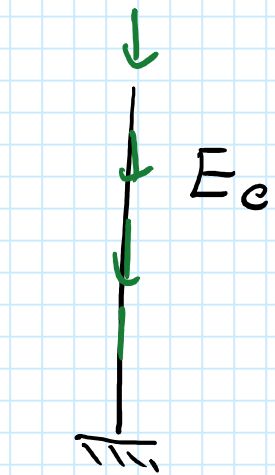

Plinto

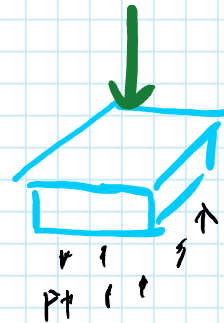

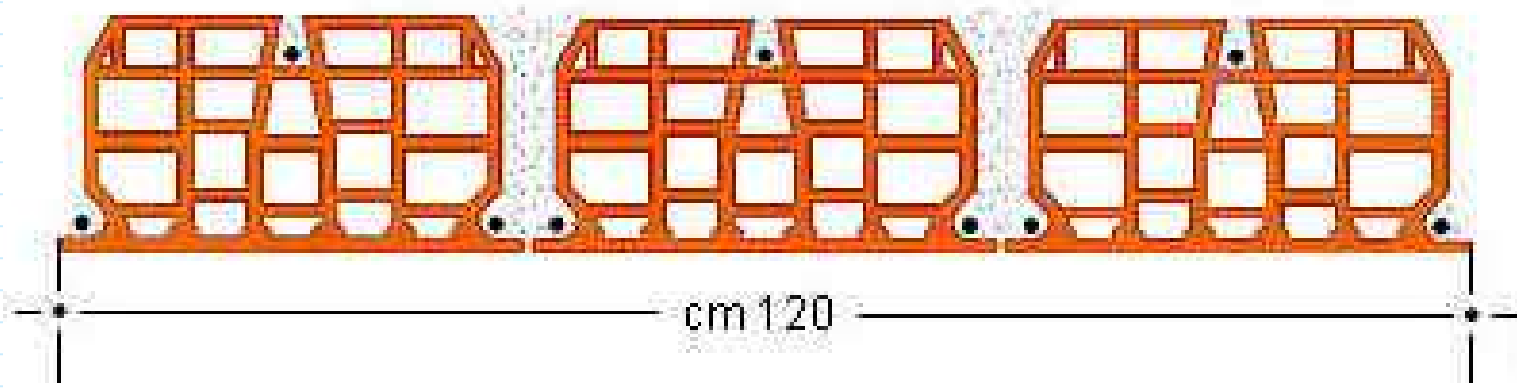
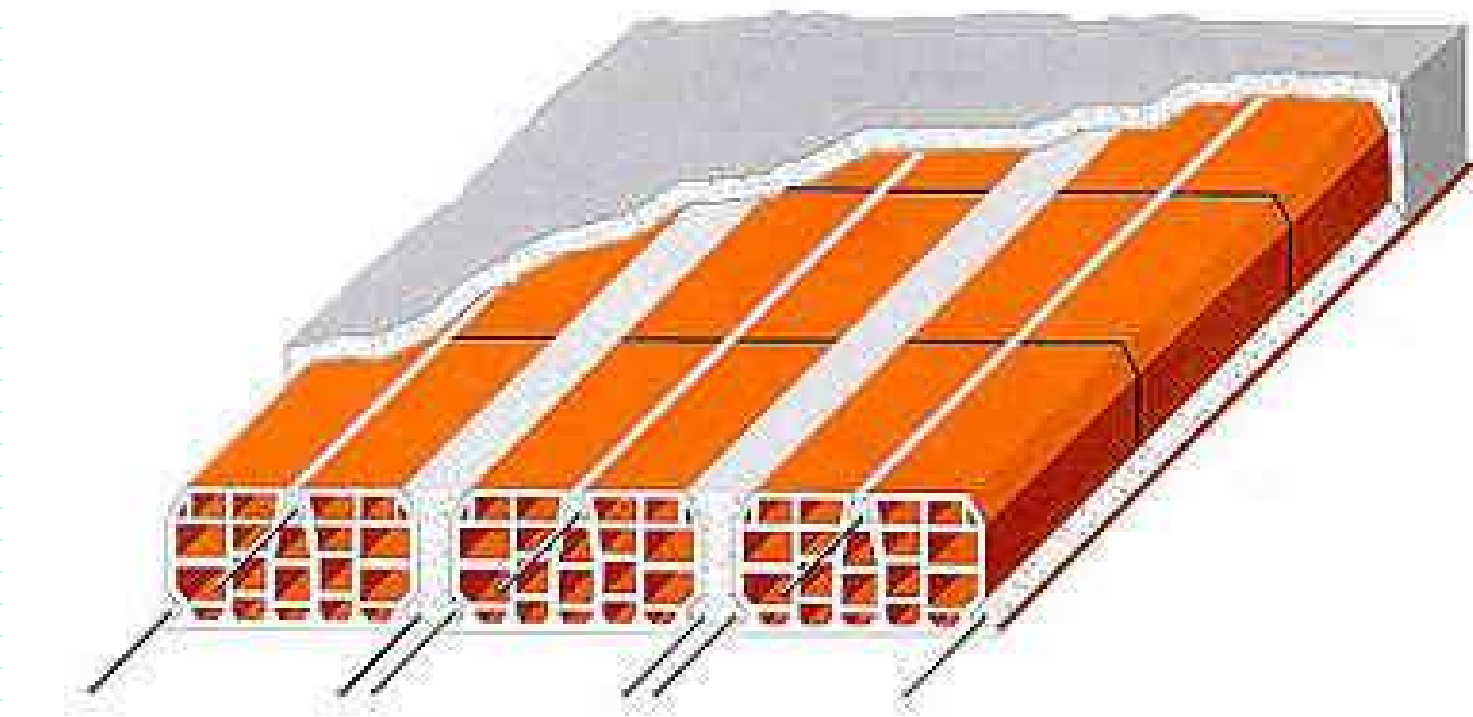



Trave emergentă

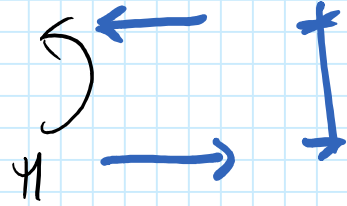
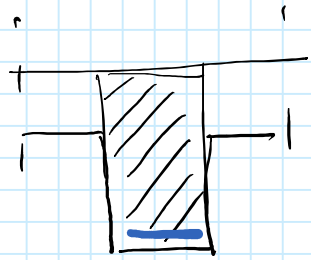

- Pini rigide e rezistente

- Si vede

Trave scurta

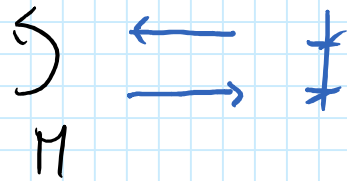
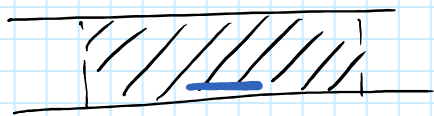

- Flexibile e foarte rezistente

- Non si vede

Plinti:

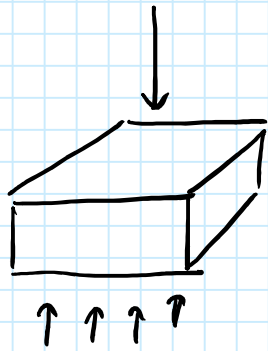

Strutture di fondazione  
Fondazioni superficiali

Tram di fondazione

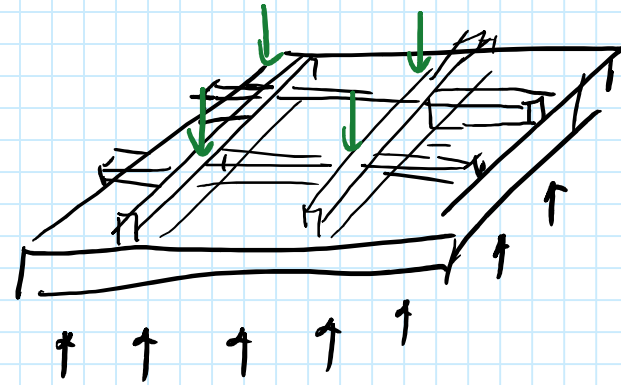
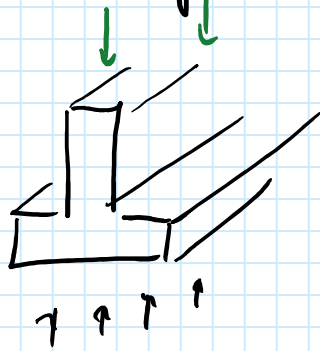

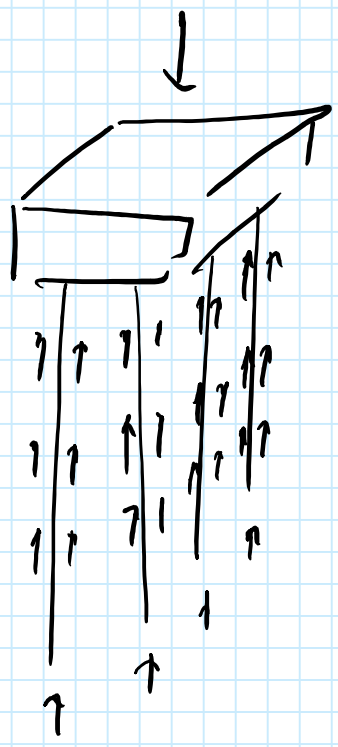

Struttura di fondazione

Plinti su pali

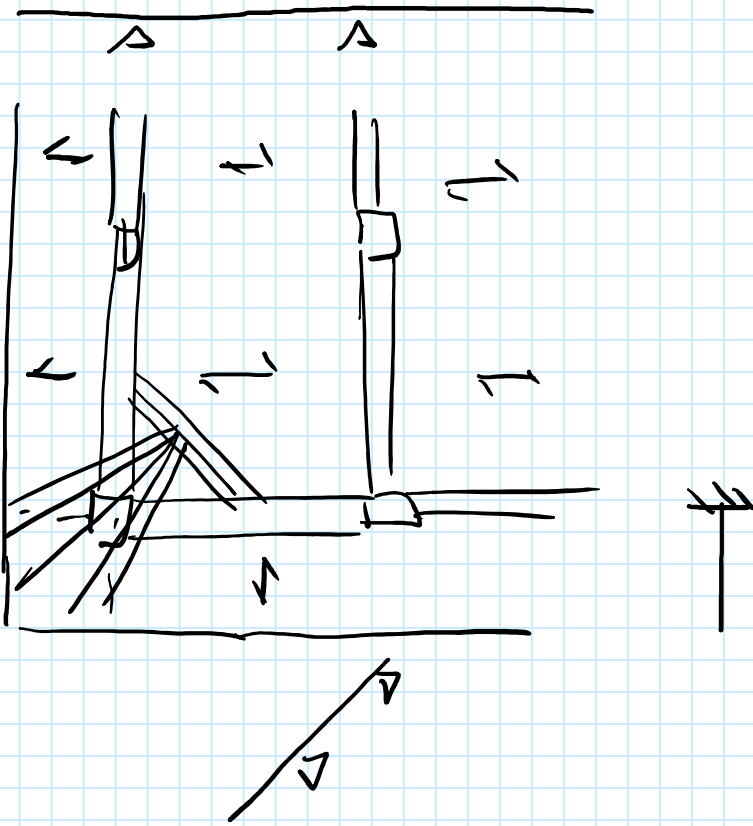

Sholati

1. Sholas in presension
2. Shola lateral
3. Sholo d'angolo

# SCALE

Solita rampante

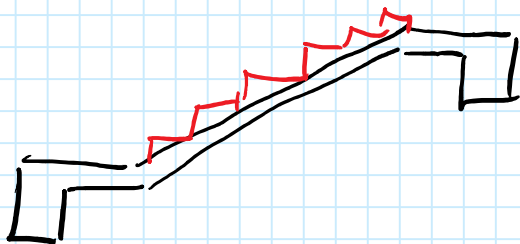
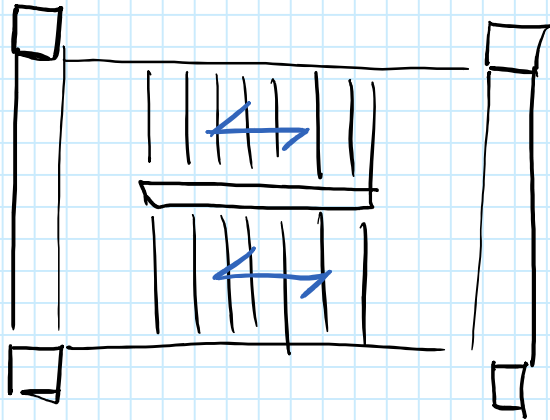

Torre e ginocchio e gradini a sbalzo

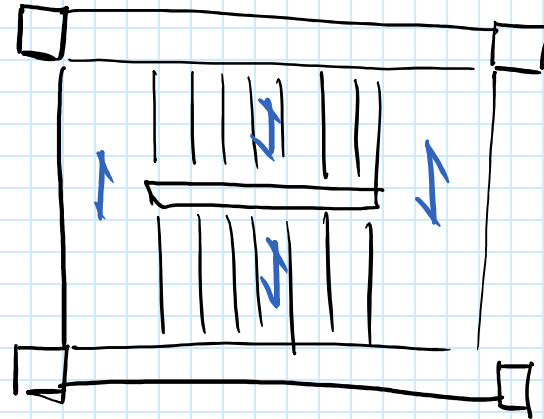



# Scale alle G. liberti

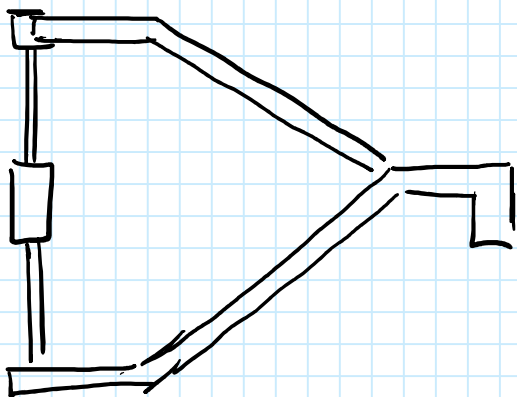
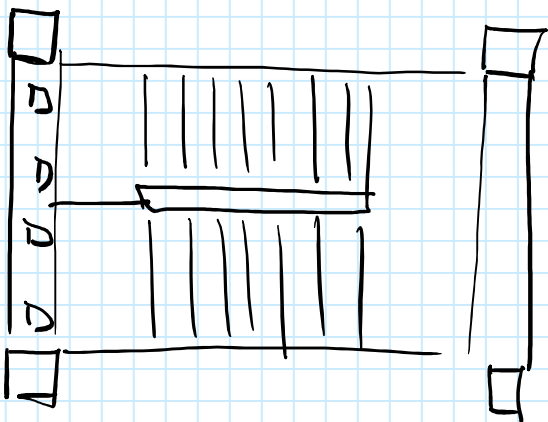

Fiori mei solari

